

How to: Setting up the DCS-5000L with mydlink Lite App on Android Device by WPS?

Step 1: Connect the power of the camera and connect LAN cable from the camera to your router.

Step 2: Open **Mydlink Lite** Apps on your mobile phone.

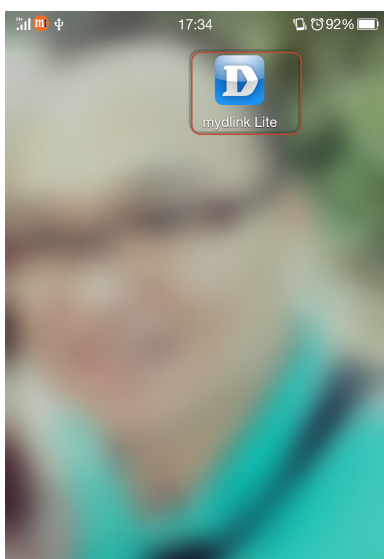

Step 3: Click on **New users, sign up here.**

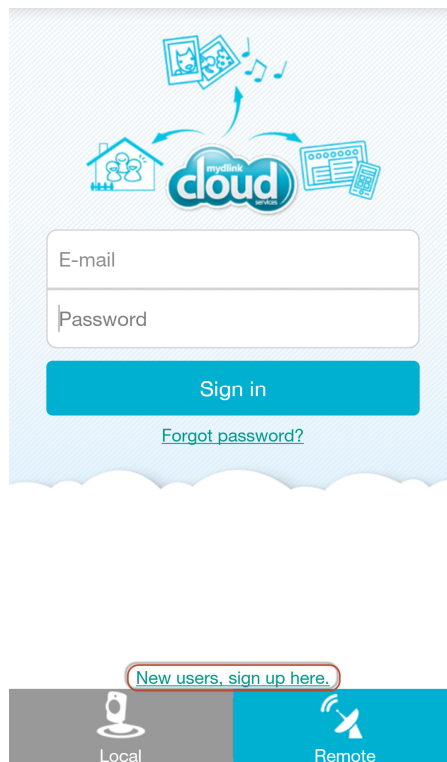

Step 4: Click on **Yes.**

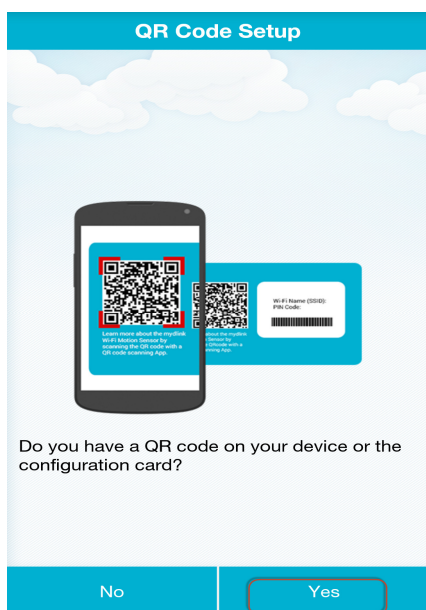

Step 5: Scan the **QR Code** on the device.



Step 6: Click on **Next**

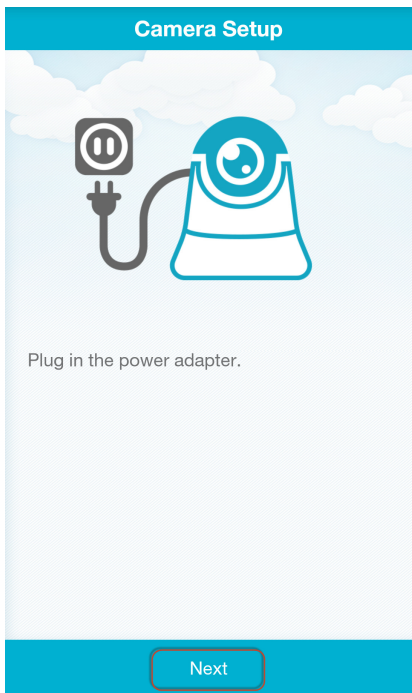

Step 7: Click on **Yes**



Step 8: Press the **WPS** button on your router and press **Next**

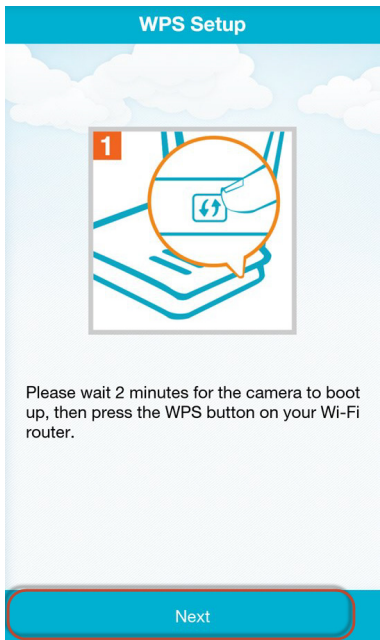

Step 9: Press the **WPS** button on your Camera and press **Next**

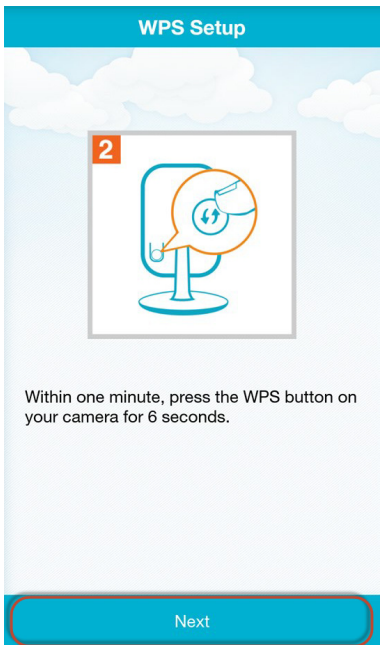

Step 10: Wait for the **Camera Power Led** to turn solid green first. Press **Ready**.

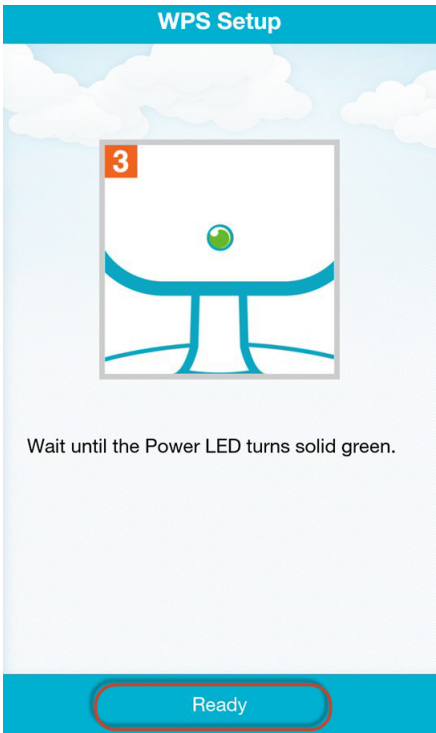

Step 11: Type a **Password** for the Camera. Click on **Next**.

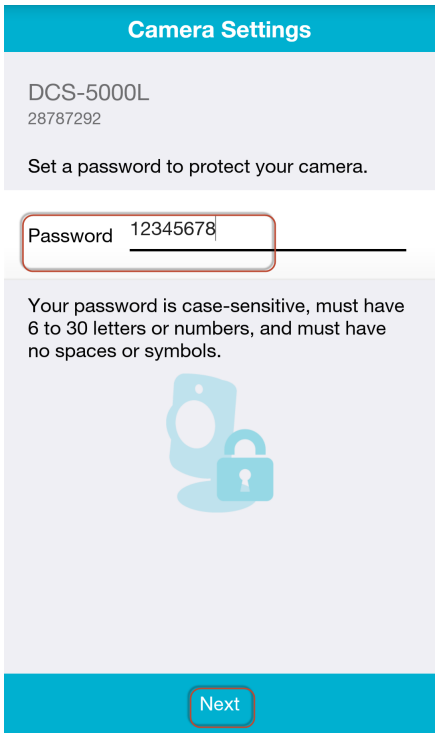

Step 12: Click On **OK**.

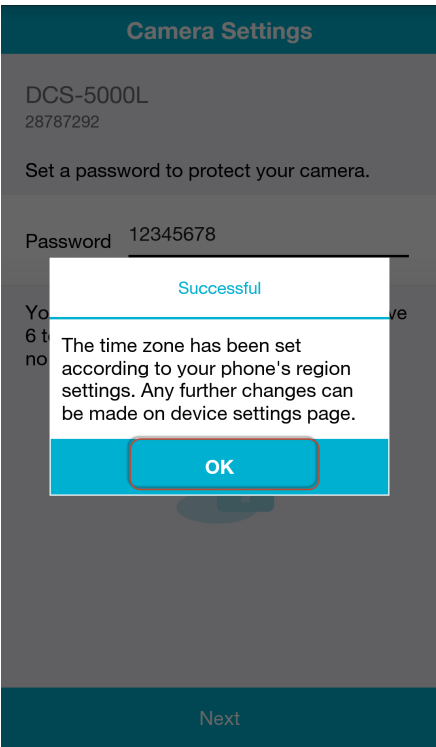

Step 13: Select **Create a new mydlink account**.

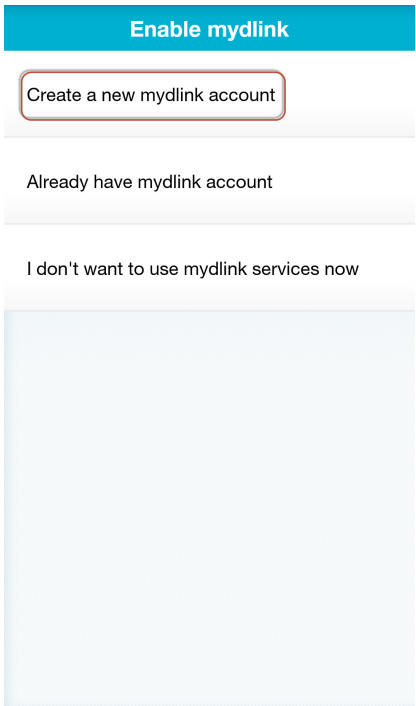

Step 14: Click on Accept

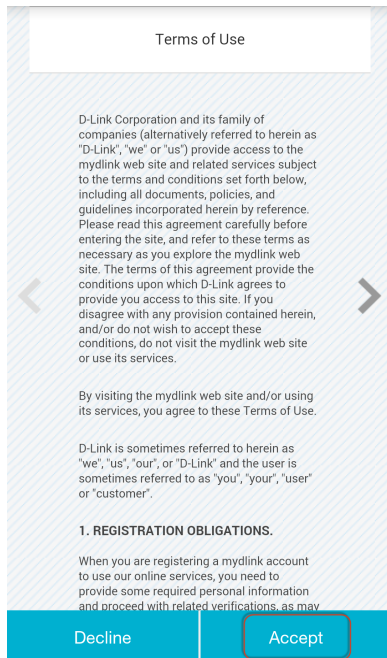

Terms of Use

D-Link Corporation and its family of companies (alternatively referred to herein as "D-Link", "we" or "us") provide access to the mydlink web site and related services subject to the terms and conditions set forth below, including all documents, policies, and guidelines incorporated herein by reference. Please read this agreement carefully before entering the site, and refer to these terms as necessary as you explore the mydlink web site. The terms of this agreement provide the conditions upon which D-Link agrees to provide you access to this site. If you disagree with any provision contained herein, and/or do not wish to accept these conditions, do not visit the mydlink web site or use its services.

By visiting the mydlink web site and/or using its services, you agree to these Terms of Use.

D-Link is sometimes referred to herein as "we", "us", "our", or "D-Link" and the user is sometimes referred to as "you", "your", "user" or "customer".

1. REGISTRATION OBLIGATIONS.

When you are registering a mydlink account to use our online services, you need to provide some required personal information and proceed with related verifications as may

Decline Accept

Step 15: Enter information to register mydlink account.

Click on Sign-up

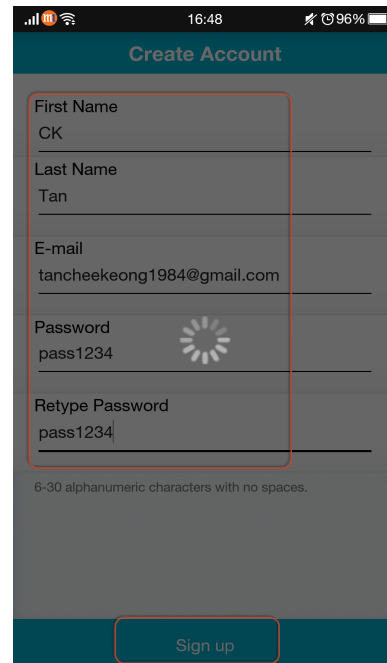

Create Account

First Name
CK

Last Name
Tan

E-mail
tancheekeong1984@gmail.com

Password
pass1234

Retype Password
pass1234

6-30 alphanumeric characters with no spaces.

Sign up

Step 16: Click on OK.

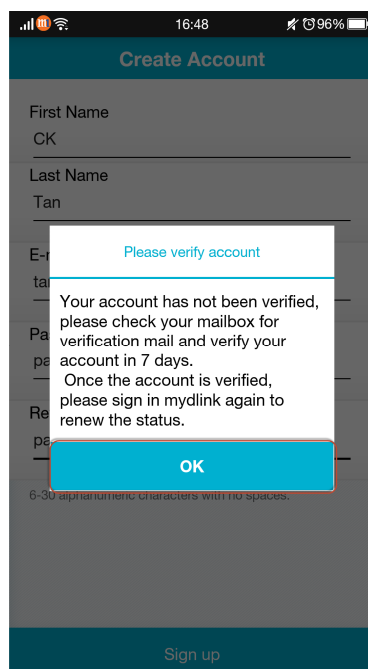

Create Account

First Name
CK

Last Name
Tan

E-mail
tan

Pa
ta
pe
pe
Re
pe

Please verify account

Your account has not been verified, please check your mailbox for verification mail and verify your account in 7 days. Once the account is verified, please sign in mydlink again to renew the status.

OK

6-30 alphanumeric characters with no spaces.

Sign up

--- END ---