

D-Link® Technical Support Setup Procedure

Setup Wizard - Setting Up the DCS-5020L WITH mydlink Account

Step 1: Run the CD Set-Up that came with the DCS-5020L. On the Set-Up Wizard screen click on **Set up your Cloud Camera** button.

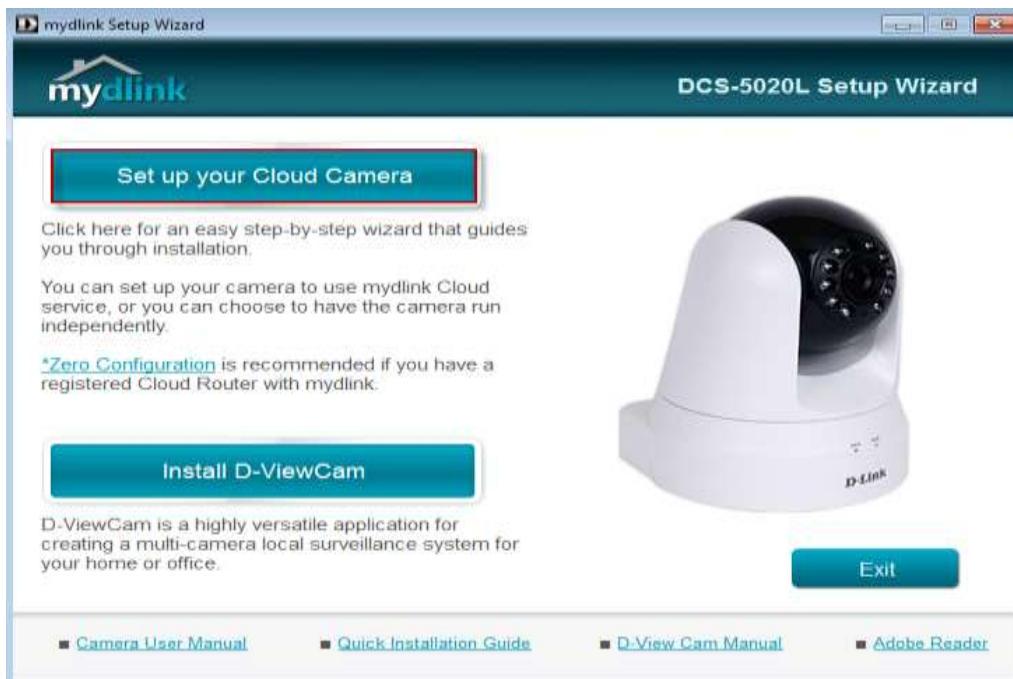

Step 2: Click on **Start** button on the next window that comes up.

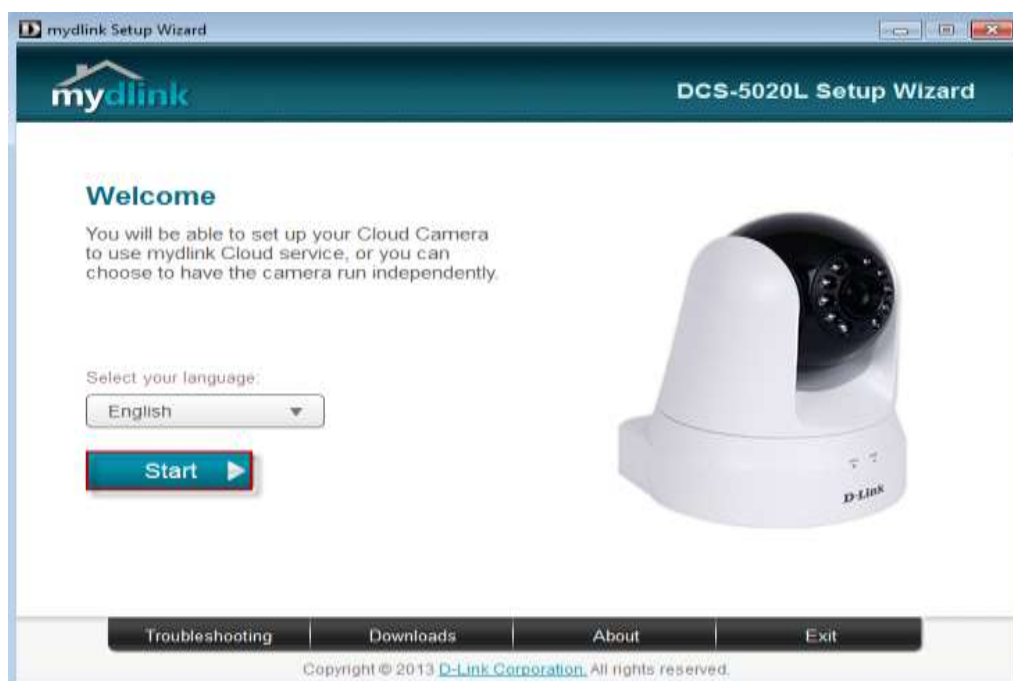

Step 3: Under End User License Agreement, put a check mark on **I accept these Terms and Conditions**, then click on **Next** button.



Step 4: Plug the included Ethernet cable into the port on the back of the Cloud Camera, then Click on **Next** button to continue.

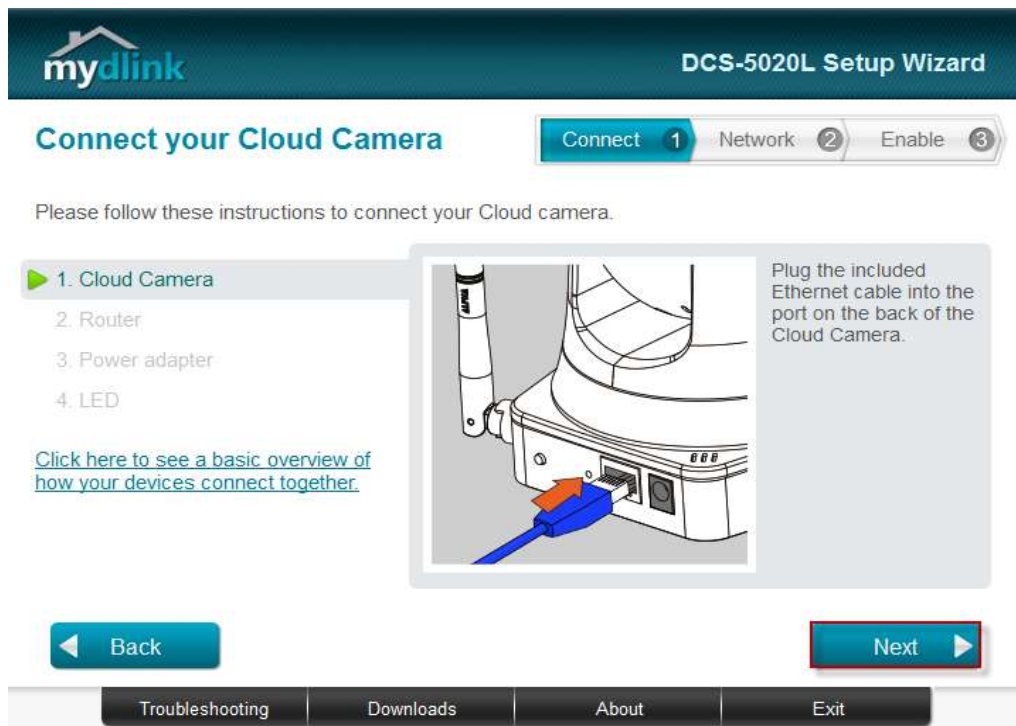

Step 5: Plug the other end of the cable into the LAN port on your router. Click **Next** button to continue.

mydlink DCS-5020L Setup Wizard

Connect your Cloud Camera

Connect 1 Network 2 Enable 3

Please follow these instructions to connect your Cloud camera.

1. Cloud Camera
2. Router
3. Power adapter
4. LED

[Click here to see a basic overview of how your devices connect together.](#)

Plug the other end of the cable into a LAN port on your router.

Back Next

Troubleshooting Downloads About Exit

Step 6: Connect the power adapter to the power connector on the back of the DCS-5020L, then plug the adapter into a power outlet. Click **Next** button.

mydlink DCS-5020L Setup Wizard

Connect your Cloud Camera

Connect 1 Network 2 Enable 3

Please follow these instructions to connect your Cloud camera.

1. Cloud Camera
2. Router
3. Power adapter
4. LED

[Click here to see a basic overview of how your devices connect together.](#)

Connect the power adapter to the power connector on the back of the DCS-5020L, then plug the adapter into a power outlet.

Back Next

Troubleshooting Downloads About Exit

Step 7: The LED on the cloud camera will turn solid green when it is ready, Click **Next** button to proceed.

The screenshot shows the 'mydlink DCS-5020L Setup Wizard' interface. At the top, the 'mydlink' logo is on the left and 'DCS-5020L Setup Wizard' is on the right. Below the logo, the title 'Connect your Cloud Camera' is displayed. A progress bar shows three steps: 'Connect' (1), 'Network' (2), and 'Enable' (3). The 'Connect' step is currently active. Below the progress bar, the text reads: 'Please follow these instructions to connect your Cloud camera.' A list of steps is shown on the left: 1. Cloud Camera, 2. Router, 3. Power adapter, and 4. LED (highlighted with a green arrow). Below the list, there is a link: 'Click here to see a basic overview of how your devices connect together.' In the center, there is an image of the back of a D-Link camera showing two LEDs: 'WPS' (black) and 'PWR' (green). To the right of the image, the text says: 'The LED on the Cloud Camera will turn solid green when it is ready.' Below this text is a link: '*What should I do if the LED stays red?'. At the bottom of the wizard, there are two buttons: 'Back' (left arrow) and 'Next' (right arrow). Below the buttons, there is a navigation bar with four tabs: 'Troubleshooting', 'Downloads', 'About', and 'Exit'.

Step 8: Click on the button **Yes** if the LED at the back of your camera is lit solid green.

Is the LED on the Cloud Camera lit solid green ?

Step 9: You will now see the camera device information with its corresponding IP Settings and MAC Address. Create a password for your camera then, Click on the **Next** button.

mydlink DCS-5020L Setup Wizard

Select your Cloud Camera

Connect 1 Network 2 Enable 3

Cloud Camera	MAC ID	IP address	Connection
DCS-5020L	28:10:7B:09:77:66	192.168.0.105	DHCP

Searching Cloud Cameras...

Registered with mydlink Not registered Wired Wireless

Can't find your Cloud Camera in the list ?

Please enter a password to secure your camera.

Admin account: admin

Password:

Confirm password:

Back Rescan Next

Troubleshooting Downloads About Exit

Step 10: Select the radio button **Ethernet cable** on the next screen then, Click on **Next** button.

mydlink DCS-5020L Setup Wizard

Choose a connection

Connect 1 Network 2 Enable 3

How will you connect your Cloud Camera to the router ?
(Current connection : **Wired connection**)

Wired connection

Ethernet cable

[*Show me how](#)

Wireless connection

By using Wi-Fi Protected Setup (WPS)

By selecting a wireless network

Back Next

Troubleshooting Downloads About Exit

Step 11: Select the radio button "**Yes, I already have a mydlink account**". Please enter the following information to sign up for a mydlink account;

E-Mail : Enter your email address
Password : Enter your password

Click on **Next** button to continue.

mydlink DCS-5020L Setup Wizard

Enable mydlink services Connect 1 Network 2 **Enable 3**

Do you have a mydlink account ?

Yes, I already have a mydlink account

E-Mail: pcomendador@dlink.com.sg

Password: *****

[Forgot your password ?](#)

No, I want to sign up for a new account.

I don't want to enable mydlink cloud service.

Back Next

Troubleshooting Downloads About Exit

Step 12: Setup is Complete. Click on **Finish** button.

Setup is complete

Connect ① Network ② Enable ③

- You can now go to mydlink.com to view and manage your Cloud Camera.

mydlink account: pcomendador@dlink.com.sg
Password: xxxxxx

- You can learn more about mydlink apps for mobile devices at mydlink.com.

- Cloud Camera Name: DCS-5020L



- [More details about your Cloud Camera.](#)

- Add an Internet shortcut for mydlink to my desktop and create a browser bookmark.



Finish

Troubleshooting

Downloads

About

Exit

Step 13: You are now ready to access the camera using the mydlink account. Open now your web browser and type in on the address bar <http://sg.mydlink.com> and then press on the enter key on your keyboard.



Step 14: Enter the E-Mail Address and the Password used to register on mydlink and then click on the **Sign in** button.

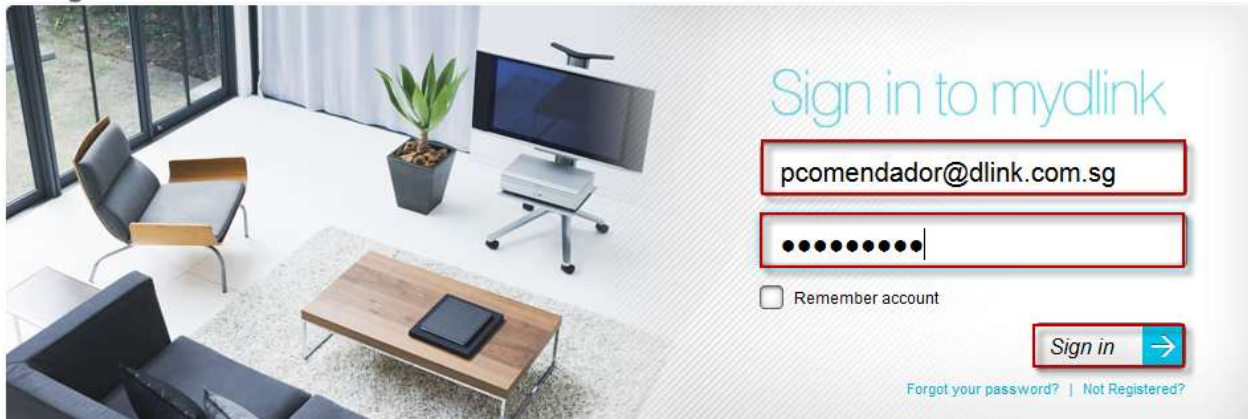

Step 15: The image of the camera will now show up on your mydlink account.

